

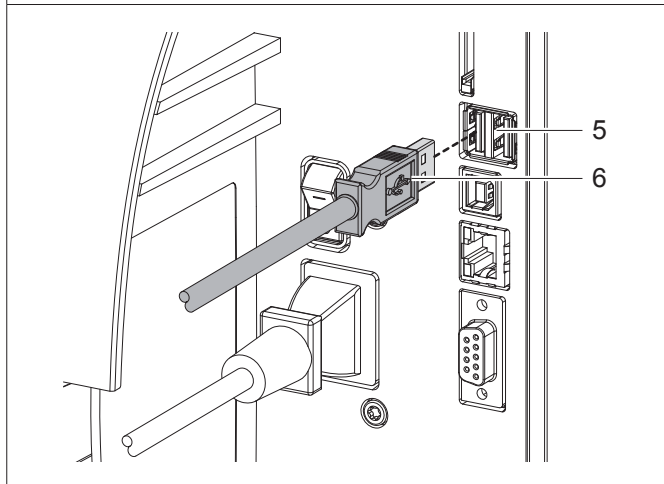

External Display Panel for BradyPrinter i5100/i7100 (Part No. 151149)

Edition: March 2020

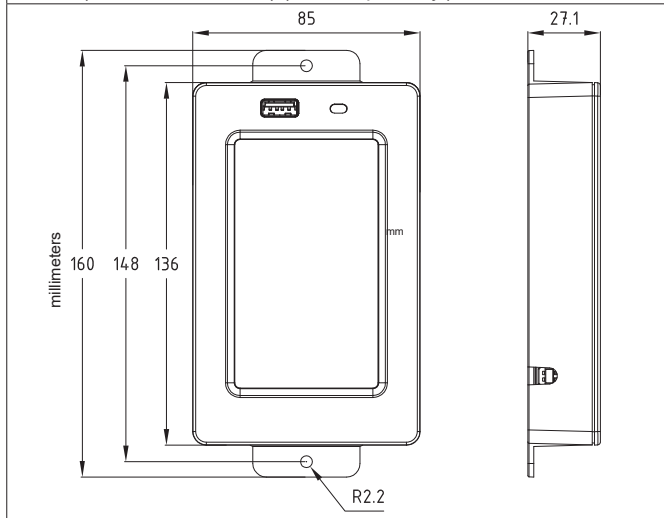
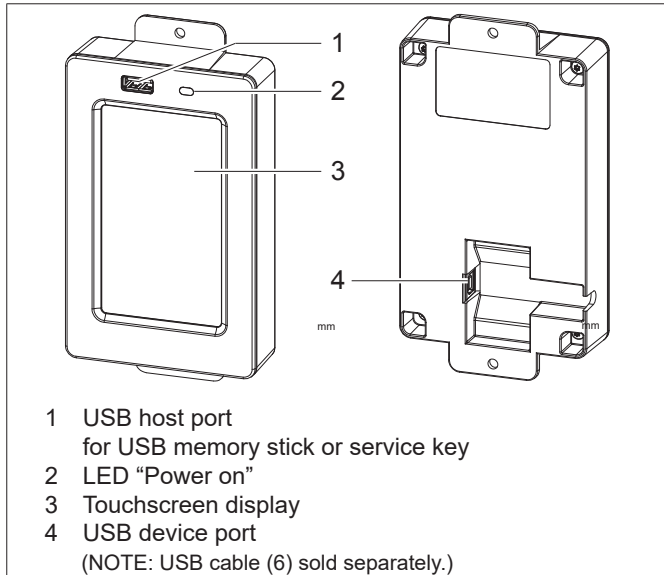

Intended Use

The external display panel is intended for the wired remote control of the i5100 and i7100 printers.

Function



Attention!

For using the external display panel the printer firmware version 5.25 or higher is needed.

The external display panel has the same functionality as the on-board display panel of the printer. Users are free to choose whether to operate the printer on the external display or on the one integrated in the device. The contents of both displays are identical and can be displayed in portrait or landscape mode. The external display panel has a USB host port (1) to connect a USB memory stick or the service key, and a USB device port (4) to connect the printer.



Attention!

To access the USB memory stick on the external display panel no other USB memory stick may be connected to the printer.

Connecting the Display

For the connection, a USB cable is **available separately**:

- 151150 USB cable w/ Type A/Type B connectors - 1.8m
- 151151 USB cable w/ Type A/Type B connectors - 3m
- 151152 USB cable w/ Type A/Type B connectors - 5m



Attention!

The use of other cables can cause loss of function.

- Use an approved USB cable (6) with USB Type A connector on one end and USB Type B connector on the other end. Insert Type A connector to one of the USB host ports (5) on the printer, and connect the Type B connector to the USB device port (4) on the external display. The cable may be connected during operation. The external display will be detected by the printer and can be used after a few seconds.

Licenses

Reference to the EU Declaration of Conformity

The External Display Panel complies with the relevant fundamental regulations of the EU Rules for Safety and Health:

- Directive 2014/30/EU relating to electromagnetic compatibility
- Directive 2011/65/EU on the restriction of the use of certain hazardous substances in electrical and electronic equipment

EU Declaration of Conformity bradyeuropa.com/conformity

FCC and Country-Specific Agency Approval Information

NOTE : This equipment has been tested and found to comply with the limits for a Class A digital device, pursuant to Part 15 of the FCC Rules. These limits are designed to provide reasonable protection against harmful interference when the equipment is operated in a commercial environment. The equipment generates, uses, and can radiate radio frequency and, if not installed and used in accordance with the instruction manual, may cause harmful interference to radio communications. Operation of this equipment in a residential area is likely to cause harmful interference in which case the user may be required to correct the interference at his own expense. Changes or modifications not expressly approved by the party responsible for compliance could void the user's authority to operate the equipment. This device complies with Part 15 of the FCC Rules. Operation is subject to the following two conditions: (1) This device may not cause harmful interference and, (2) this device must accept any interference received, including interference that may cause undesired operation.

Prop 65 Warning Statement

Prop 65 information related to this product is available at BradyID.com/i7100compliance.

Canada

ICES-003 Class A Notice, Classe A

This Class A digital apparatus meets all requirements of the Canadian Interference-Causing Equipment Regulations. Cet appareil numérique de la classe A respecte toutes les exigences du Règlement sur le matériel brouilleur du Canada.

CAN ICES-3 (A)/NMB-3(A)



Warning!

This is a class A product. In a domestic environment this product may cause radio interference in which case the user may be required to take adequate measures.

Technical Support

For repair or technical assistance, locate your regional Brady Technical Support office by going to:

- United States: bradyid.com/techsupport
- Europe: bradyeuropa.com/services
- Asia Pacific: brady.co.uk/landing-pages/global-landing-page
- Australia: bradyid.com.au/en-au/supportlanding
- Canada: bradycanada.ca
- Mexico: bradyid.com.mx/es-mx/contacto
- Latin America: bradylatinamerica.com

Registration Information

To register your printer go to:

- bradycorp.com/register

Brady Worldwide, Inc
6555 West Good Hope Road
Milwaukee, WI 53223
bradyid.com

Brady EMEA
Lindestraat 20
9240 Zele
Belgium
bradycorp.com/global

Brady Corporation Asia
1 Kaki Bukit Crescent
Singapore 416236
bradycorp.com/global

