

Organise
your workplace

CONTENTS

- 3** Why this guide?
- 4** Floor marking benefits
- 7** Compliance
- 10** Effective floor marking: 9 tips
- 20** A floor marking colour code
- 21** The right tools for the job



Why this guide

Floor marking can help to increase workplace safety, efficiency and compliance. Separated traffic lanes for pedestrians and forklifts or light vehicles will reduce workplace accidents or near misses, will increase workplace compliance with regulations and may positively affect working efficiency. Clearly marked areas for pallets, raw materials, finished goods and scrapped goods can further enhance productivity, as long as the colour coding stays clear for all relevant workers.

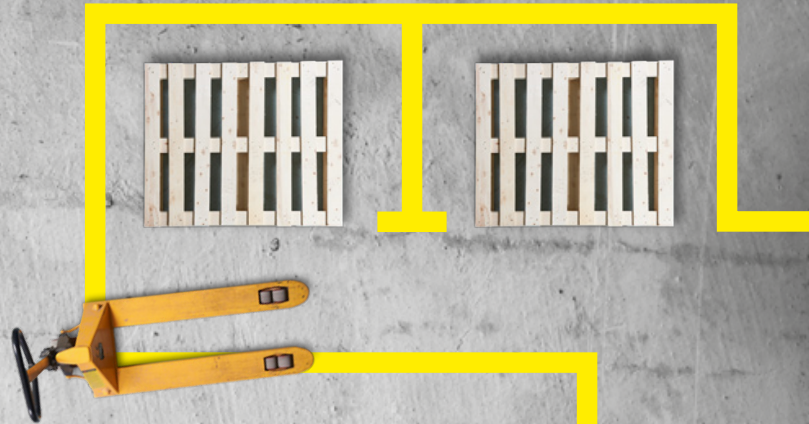

This floor marking guide offers tips for effective floor marking, a floor marking colour code suggestion and includes information on quality floor marking solutions as well as a number of product selection criteria.



Floor marking benefits

Using consistent, colour-coded floor marking in your workplace can lead to increased efficiency and improved safety.



Leaner, more efficient operations

When you have a consistent floor marking colour system, employees are able to associate certain colours with certain areas or actions. This allows them to quickly and easily move around the facility to complete their tasks and find what they are looking for.

- Colour code information: when workers are looking for a certain material storage area, knowing what colour floor marking to look for helps to find it faster.
- Show associations: If you mark a cart with a certain colour tape or paint, and also mark off the area the cart belongs in with the same colour tape or paint, workers can easily associate the cart with its intended location.

Improved safety

By using a standard colour-coding for floor tape and paint, you can easily warn workers at-a-glance of hazardous areas, equipment or forklift traffic paths. Workplace safety is improved when employees are visually aware of unsafe areas, when items are stored in their designated areas and when safe walking paths and exit routes are clearly marked.

- Mark traffic lanes: marking aisle ways and exit paths throughout your facility helps to emphasise the safest path to walk through. This helps to keep pedestrians and forklifts safe, and provides quick egress guidance in an emergency.
- Highlight unsafe areas: hazards that are consistently marked with bright colours (red/yellow) quickly tell employees which areas are unsafe or should be kept clear.



Compliance

Floor marking can support compliance with European Union laws & regulations. In EU Directive Annexes, colour codes are mentioned for a number of floor marking applications.

Directive 92/58/EEC Minimum requirements for the provision of safety and /or health signs at work

The directive includes that employers shall provide safety and/or health signs where hazards cannot be avoided or adequately reduced by techniques for collective protection or measures, methods or procedures used in the organisation of work.



ANNEX I - GENERAL MINIMUM REQUIREMENTS CONCERNING SAFETY AND/OR HEALTH SIGNS AT WORK

- 2.1.4. Traffic routes must be permanently marked with a safety colour.
6. Depending on requirements, signs and signalling devices must be cleaned, maintained, checked, repaired, and if necessary replaced on a regular basis to ensure that they retain their intrinsic and/or functional qualities.

ANNEX V - MINIMUM REQUIREMENTS GOVERNING SIGNS USED FOR OBSTACLES AND DANGEROUS LOCATIONS, AND FOR MARKING TRAFFIC ROUTES

- 1.1. Places where there is a risk of colliding with obstacles, of falling or of objects falling should be marked with alternating yellow and black, or red and white stripes in built-up zones in the undertaking to which workers have access during their work.
- 1.3. The yellow and black or red and white stripes must be at an angle of approximately 45° and of more or less equal size.
- 2.1. Where the use and equipment of rooms so requires for the protection of workers, traffic routes for vehicles must be clearly identified by continuous stripes in a clearly visible colour, preferably white or yellow, taking into account the colour of the ground.
- 2.2. The stripes must be located so as to indicate the necessary safe distance between the vehicles and any object which may be nearby, and between pedestrians and vehicles.



Effective floor marking: 9 tips

Apart from the colours mentioned in the previous pages about compliance, no further regulations or widely accepted standards exist to support companies in establishing a floor marking colour code. As a worldwide supplier of floor marking, Brady suggests 9 tips that can serve as a basis to establish a floor marking colour code based on best practices.



1.

Use as few colours as possible.



2.

Colour-code work cell and equipment borders.



3.

Colour-code material storage areas.



4.

Colour-code non-material storage fixtures.

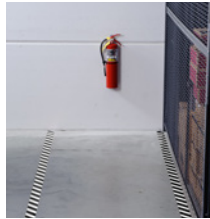

5.

Colour-code areas to be kept clear for safety and compliance.



6.

Colour-code areas in front of electrical panels.



7.

Colour-code operational “keep clear” areas.



8.

Colour-code hazardous areas or equipment.



9.

Mark means of egress.

1. Use as few colours as possible.

This makes it easier for employees to remember the meaning of each colour and reduces the number of floor marking products in inventory.



2. Colour-code work cell and equipment borders.

Some companies choose to mark equipment locations using the same colour in use for aisle ways and work cell boundaries. This has the benefit of simplicity. However, the overall layout of lanes and sectors within the plant is made more visually clear when different colours are used for these purposes.



3. Colour-code material storage areas.

Use the same border colour for all material storage areas, unless there is an important reason for differentiating between raw materials, work in-progress and finished goods. As an alternative, consider using one border tape or paint colour in conjunction with different coloured labels to visually distinguish between the various material types.

4. Colour-code non-material storage fixtures.

Use a different, single colour code for all fixtures that do not store materials or goods.



5. Colour-code areas to be kept clear for safety and compliance.

Select a colour of floor marking to apply in front of firefighting equipment and safety equipment where the intent is to keep the area in front of equipment clear for safety or compliance reasons. We recommend that the fire fighting and safety equipment itself - as well as any associated wall signage - be colour-coded to enhance visibility and facilitate easy location of the equipment from a distance.

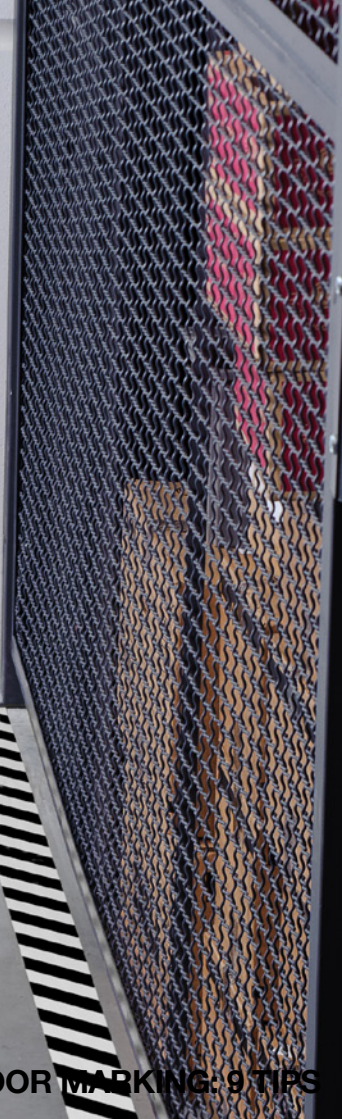

6. Colour-code areas in front of electrical panels.

The same colour can also be used to mark the floor in front of electrical panels. Some facilities may use a different colour to indicate the presence of an electrical hazard, but the primary purpose of the marking is to keep the area in front of the panel clear. Danger labels should be displayed on the outside of the panels to warn employees of potential shock and arc flash hazards.



7. Colour-code operational “keep clear” areas.

Use the same colour to indicate that an area should be kept clear for operational reasons, such as ensuring sufficient clearance for forklifts. As objects without a home tend to naturally congregate in open areas, employ floor marking to discourage the use of open floor space for unintended purposes.

KEEP CLEAR

8. Colour-code hazardous areas or equipment.

Striped floor marking could be used as a border around any area or piece of equipment where employees may be inadvertently exposed to a special hazard, such as flammable material containers. The intent of the floor marking border is to indicate that special caution should be exercised when entering and working in the area.



9. Mark means of egress.



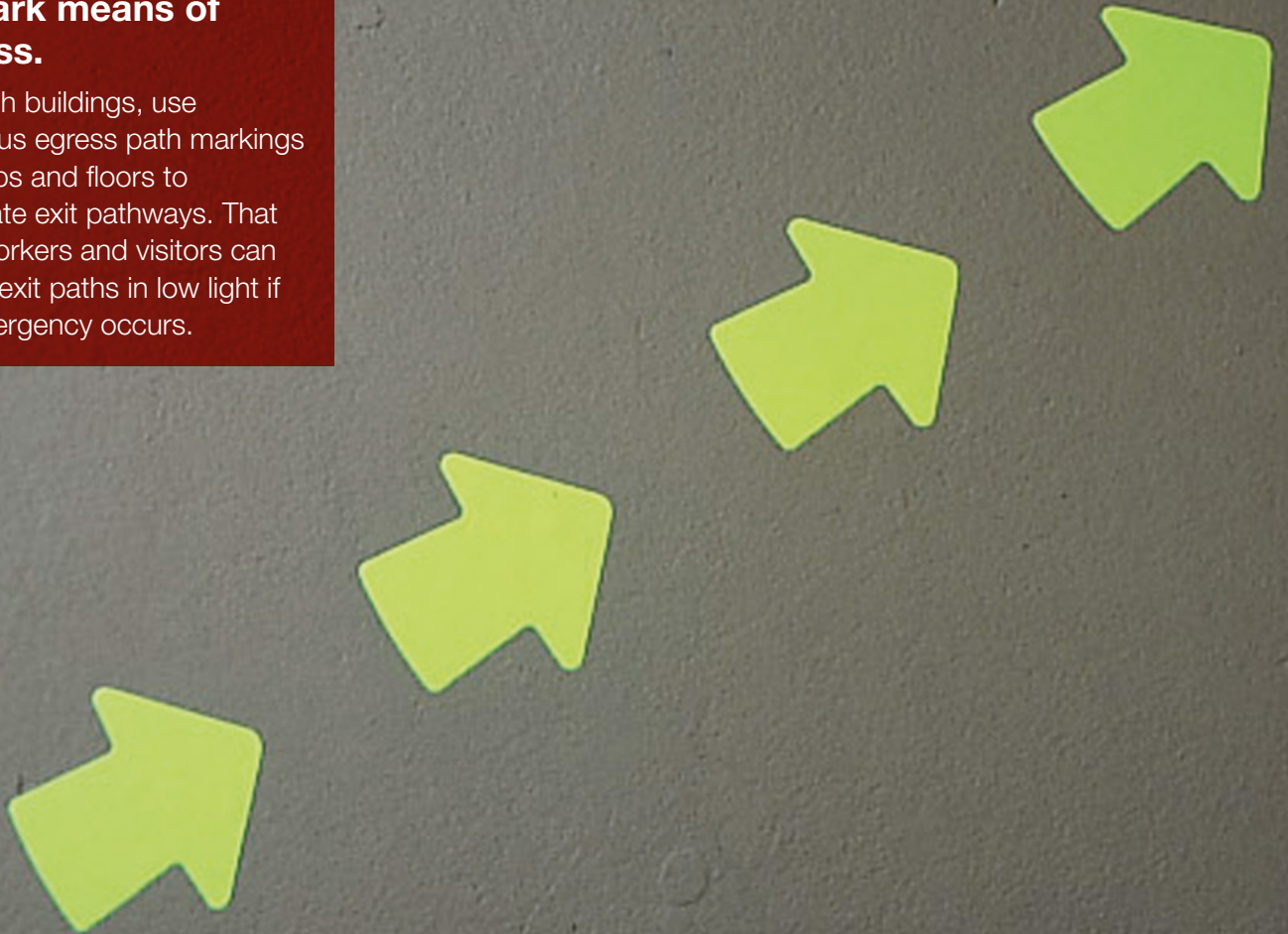



For high buildings, use luminous egress path markings on steps and floors to delineate exit pathways. That way workers and visitors can locate exit paths in low light if an emergency occurs.



A floor marking colour code

With the right colours in the right places, you can easily keep workers on the right path, identify equipment and storage areas, hazardous flooring and forklift traffic and more.

If no company colour coding standard is in place, we suggest this useful guideline to establish floor marking consistency in your workplace. No matter which colour code you decide on, it is always a good idea to train workers so they know the meaning of every colour.

Colour		Area
Yellow / White		Aisle ways, traffic lanes, work cells and traffic routes for vehicles
Blue, Green and/or Black		Materials and components, including raw materials, work-in-progress and finished goods
Orange		Materials or products held for inspection
Red		Defects, scrap, rework and red tag areas
Photoluminescent		Steps and perimeter demarcation to identify egress routes in a lights-out emergency
Black and White		Areas to be kept clear for operational purposes
Black and Yellow/Red and White		Areas that may expose employees to special physical or health hazards, risk of colliding with obstacles, of falling or of objects falling.

The right tools for the job

5 criteria for selecting floor marking products

Once you have established a floor marking colour code, the next step is to find the products to get the job done right. Here are 5 criteria to consider when selecting products:

- **Durability:** when you have durable floor marking tape or paint, you spend less time and money replacing damaged or worn lines. Look for a tape or paint product that can withstand forklift traffic, has a low-profile design to minimise tears and scratches from skids, pallets and other vehicles. Rugged polyester tape and an ultra-aggressive adhesive are key features for durability, while paint is another durable option.
- **Easy application:** the right tape and paint can easily be applied in smooth, straight lines without the help of co-workers. Stiff polyester tape with liners helps to prevent tape from stretching, which reduces wrinkles, waves and lines. Using paint and stencils also enables easy, effective application.
- **Removability:** is your company regularly making lean improvements that include reorganising equipment and infrastructure? In this case floor marking that can easily be removed without leaving residue or damaging the floor can be an important criterion.
- **Visibility:** tape and paint can provide effective visibility with a bright protected finish, a variety of high-impact colours and a surface that resists marks and smudges.
- **Shapes:** floor tape and paint are not always one-size fits all. Find a tape option or stencils that allow for dots, arrows, dashes, footprints, corners and other die-cut shapes. This gives you the flexibility and variety you need for any floor marking application.



Tools & solutions

Brady offers reliable floor marking tools & solutions for indoor and outdoor facilities with a variety of traffic types.



Vinyl aisle marking tape

Vinyl aisle marking tape is made out of vinyl. It offers fair durability and high visibility and is ideal for temporary area marking, regularly changing work cells and wall marking. It can be used to mark aisles and passageways in areas with light traffic, primarily pedestrians.

Traffic: pedestrian

Surface: smooth, clean

Colours: yellow, red, green, white, blue, black, orange, brown, purple, grey

Cost: small

Test a sample



ToughStripe

ToughStripe Floor Marking is made out of polyester. It offers great durability, easy application and high visibility. ToughStripe is ideal for marking aisles, passageways and storage locations, and pointing out important safety equipment and egress paths in areas with medium traffic, including light vehicles and pedestrians.

Traffic: pedestrian, light vehicle

Surface: smooth, clean

Solid colours: black, white, red, green, blue, yellow, orange, purple, brown, grey

Striped colours: orange/black, yellow/black, white/black, red/white, red/yellow, green/white, blue/yellow

Checkered colours: black/white, red/white

Cost: medium

Test a sample



ToughStripe Max

ToughStripe Max is made out of vinyl. It also offers superior durability, easy application and high visibility. ToughStripe Max is ideal for marking aisles, passageways and storage locations, and pointing out important safety equipment and egress paths in areas with heavy traffic, including forklifts, other warehouse vehicles and pedestrians.

Traffic: pedestrian, light vehicle, forklift

Surface: smooth, clean

Solid colours: yellow, blue, red, orange, green, white

Striped colours: yellow/black

Cost: premium

Test a sample

ToughStripe Floor Tape Applicator

Easily draw straight lines of reliable floor tapes with the ToughStripe Floor Tape Applicator to increase safety and efficiency in your facilities. With just one tool, you can create heavy traffic forklift lanes, traffic lanes for pallet trucks and safe walking areas for coworkers on foot in your facilities. The ToughStripe Floor Tape Applicator works with Brady's complete good, better, best floor marking tape offer.

- applies thin and temporary up to thick, heavy duty floor tapes
- ergonomic and lightweight for comfortable use
- winds spent floor tape liner on an extra core
- easy to store in tight spaces



PaintStripe

With PaintStripe Floor Marking Stencil, precise lines can be painted a lot faster. Distance markings on the stencils enable users to exactly map out entire floor lines or areas before applying paint. The PaintStripe stencil can quickly and securely mask floor line edges and is easy to remove. Accelerating the application of painted floor marking with PaintStripe stencils minimises project preparation time and disruption of normal operations.

Traffic: depends on paint

Surface: smooth, clean, porous, textured

Colours: depends on paint

Cost: small

Test a sample



Africa

Randburg, South Africa
Tel: +27 11 704 3295
africa@bradycorp.com

Benelux

Zele, Belgium
Tel. +32 (0) 52 45 78 11
benelux@bradycorp.com

Central & Eastern Europe

Bratislava, Slovakia
Tel. +421 2 3300 4800
central_europe@bradycorp.com

Denmark

Odense
Tel. +45 66 14 44 00
denmark@bradycorp.com

France

Roncq
Tel. +33 (0) 3 20 76 94 48
france@bradycorp.com

Germany, Austria & Switzerland

Egelsbach, Germany
Tel. +49 (0) 6103 7598 660
germany@bradycorp.com

Hungary

Budaörs
Tel. +36 23 500 275
central_europe@bradycorp.com

Italy

Gorgonzola
Tel: +39 02 26 00 00 22
italy@bradycorp.com

Middle East FZE

Dubai, UAE
Tel. +971 4881 2524
me@bradycorp.com

Norway

Kjeller
Tel. +47 70 13 40 00
norway@bradycorp.com

Romania

Bucharest
Tel: +40 21 202 3032
central_europe@bradycorp.com

Russia

Moscow
Tel: +7 495 269 47 87
central_europe@bradycorp.com

Spain & Portugal

Madrid, Spain
Tel. +34 900 902 993
spain@bradycorp.com
portugal@bradycorp.com

Sweden, Finland, Baltic States

Kista, Sweden
Tel. +46 (0) 8 590 057 30
sweden@bradycorp.com

Turkey

Istanbul
Tel. +90 212 264 02 20 / 264 02 21
turkey@bradycorp.com

UK & Ireland

Banbury, UK
Tel. +44 (0) 1295 228 288
uk@bradycorp.com

**We identify and protect people,
products and premises.**

www.bradyeurope.com

20.02.2020

EUR-M-992-EN

© 2020 Brady Worldwide inc. All rights reserved

