

Brady Workstation Mobile Text Labels App and LinkWare™ Live Instruction Guide



Android Wi-Fi both BMP51 and BMP61 Printers

Connect to LinkWare Live

1. Go to phone settings
2. Tap Wi-Fi
3. Tap the BMP51 or BMP61 printer to connect
4. Open the Brady Mobile Text Labels app
5. Select a printer and material

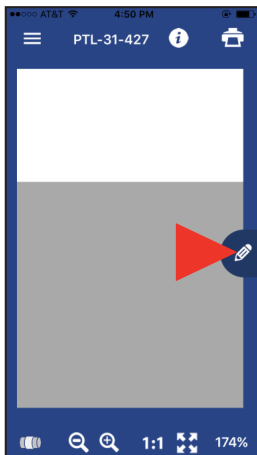

6. Tap the pencil icon, new screen appears

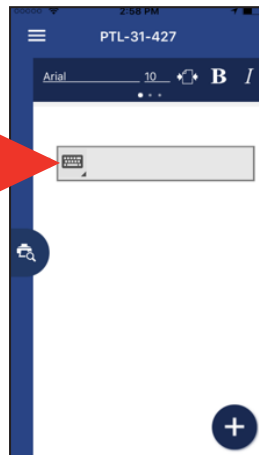

7. Tap the keyboard icon to expand icons

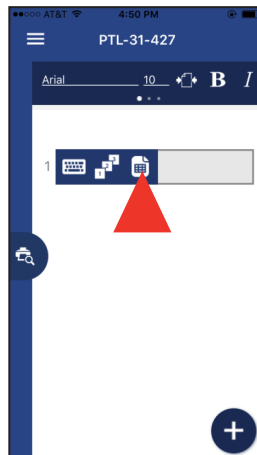

8. Tap the page icon, cloud storage options open

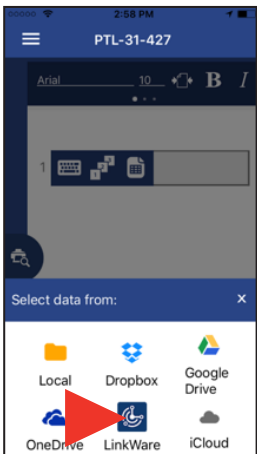

9. Tap the LinkWare icon at the bottom of the screen

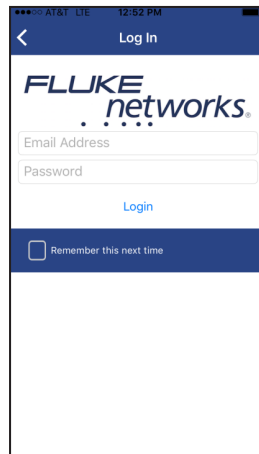

10. Enter your Fluke Networks login credentials



Importing data

Complete these steps after logging in to LinkWare Live:

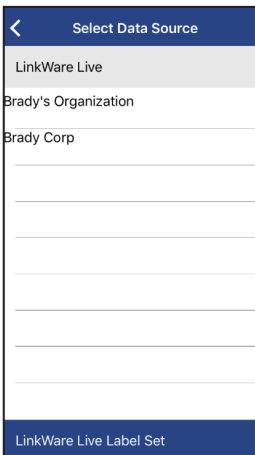

1. Select your organisation



2. Select your project

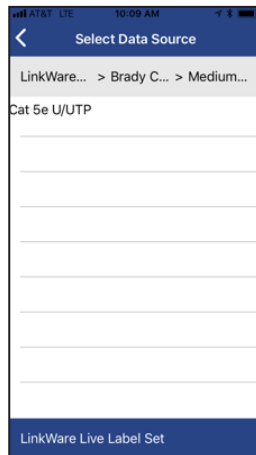

3. Select cable type

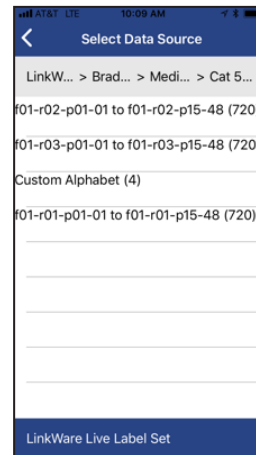

4. Select label set

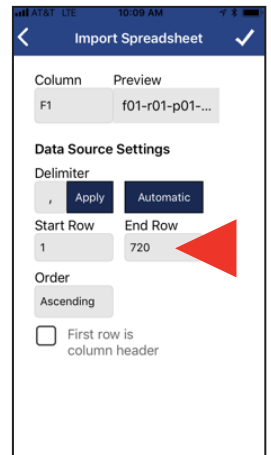

5. Set rows to print (up to 100)

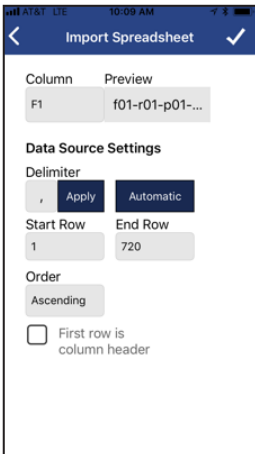

6. Confirm import setting, the data imports

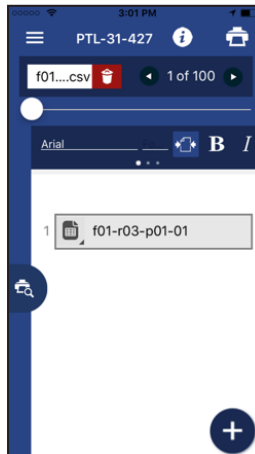

7. Apply formatting options as needed using the Formatting Toolbar

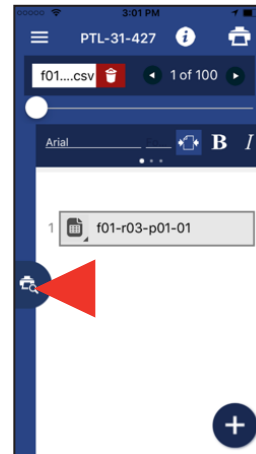

8. Tap preview icon to preview the data, the screen changes to "preview view"

Print labels

Complete these steps after importing and formatting your data:

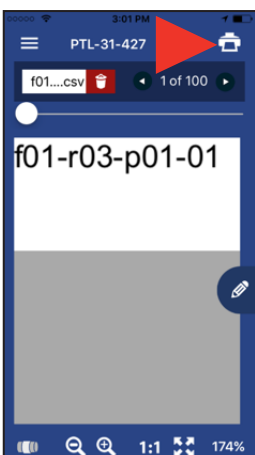

1. Tap print icon
2. Set Cutting Options and Label Set
3. Tap print

Android Bluetooth BMP51 Printer Only

Connect to LinkWare Live

1. Go to phone settings
2. Select Bluetooth
 - a. Turn Bluetooth on if it is turned off
3. Tap the BMP51 printer to connect
4. Open the Brady Mobile Text Labels app
5. Select a printer and material

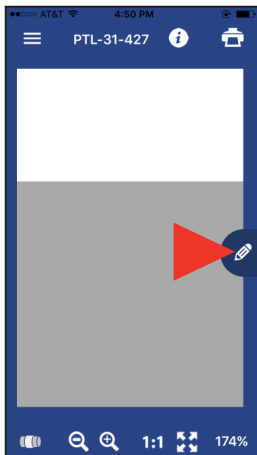

6. Tap the pencil icon, new screen appears

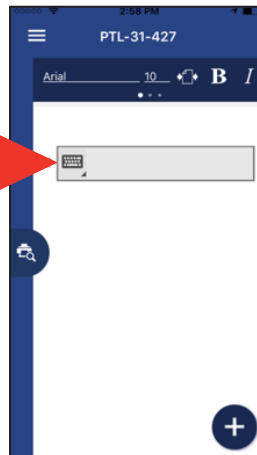

7. Tap the keyboard icon to expand icons

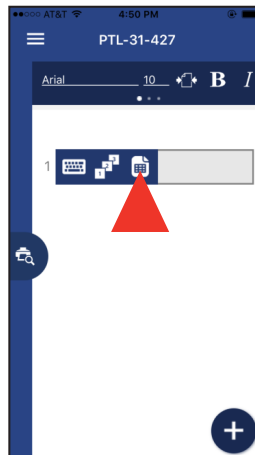

8. Tap the page icon, cloud storage options open

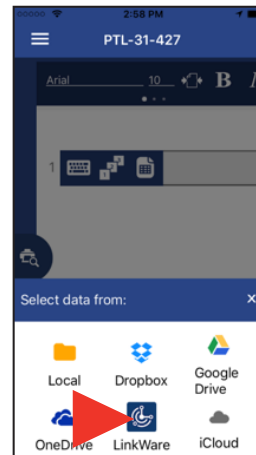

9. Tap the LinkWare icon at the bottom of the screen

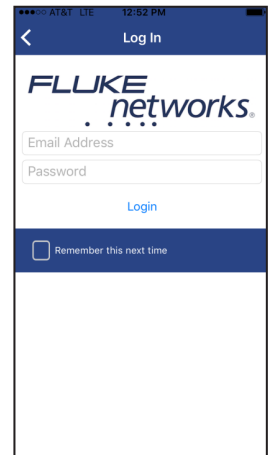

10. Enter your Fluke Networks login credentials

Importing data

Complete these steps after logging in to LinkWare Live:

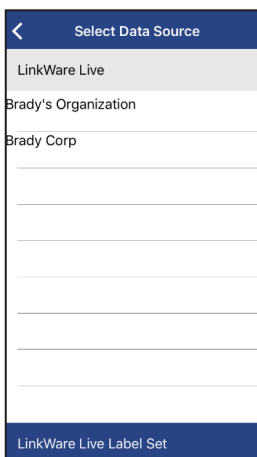

1. Select your organisation



2. Select your project

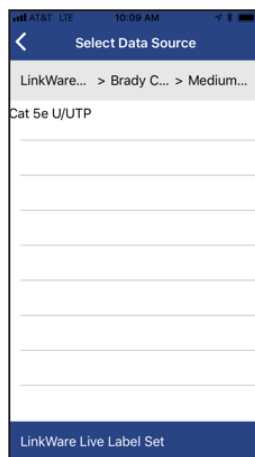

3. Select cable type

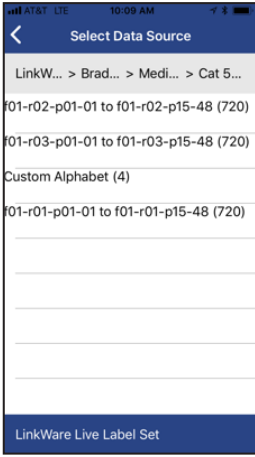

4. Select label set

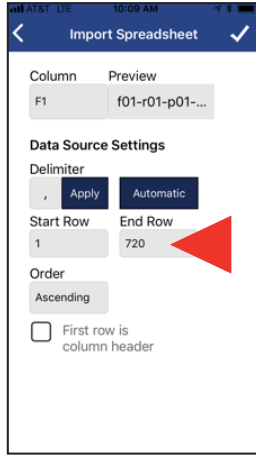

5. Set rows to print (up to 100)

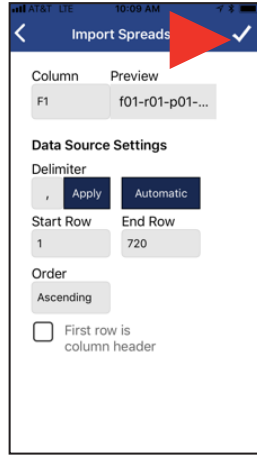

6. Confirm import setting, the data imports

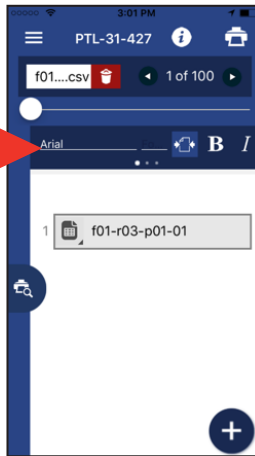

7. Apply formatting options as needed using the Formatting Toolbar

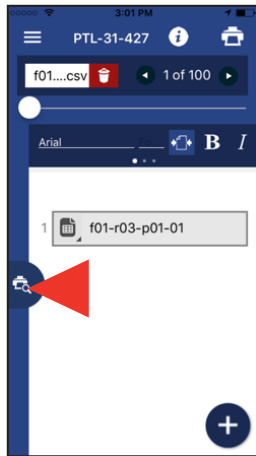

8. Tap preview icon to preview the data, the screen changes to "preview view"

Print labels

Complete these steps after importing and formatting your data:

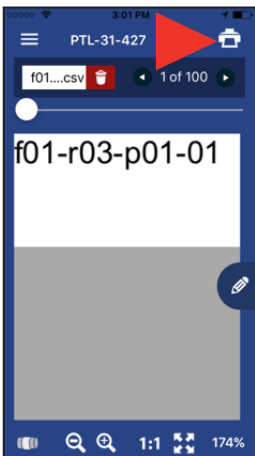

1. Tap print icon
2. Set Cutting Options and Label Set
3. Tap print



For more information, visit our websites :
www.bradyeurope.com/BMP51
www.bradyeurope.com/BMP61